

WILD BOX[®]

SHOWER

ISTRUZIONI DI MONTAGGIO

SERIE "GREEN" art. MGDO6SF80SF - REVERSIBILE - CABINA DOCCIA SEMICIRCOLARE CRISTALLO SERIGRAFATO 6MM: 80x80xH190CM.

SERIE "GREEN" art. MGDO6C80SF/MGDO6C90SF - REVERSIBILE - CABINA DOCCIA SEMICIRCOLARE CRISTALLO TRASPARENTE 6MM: 80x80xH190CM/90x90xH190CM.



NOTA IMPORTANTE: Durante il montaggio, tenere i bambini lontano dall'area di lavoro. Tenere i materiali di imballaggio (sacchetti di plastica, cartoni, ecc) e la minuteria lontano dalla portata dei bambini. Pericolo di soffocamento.

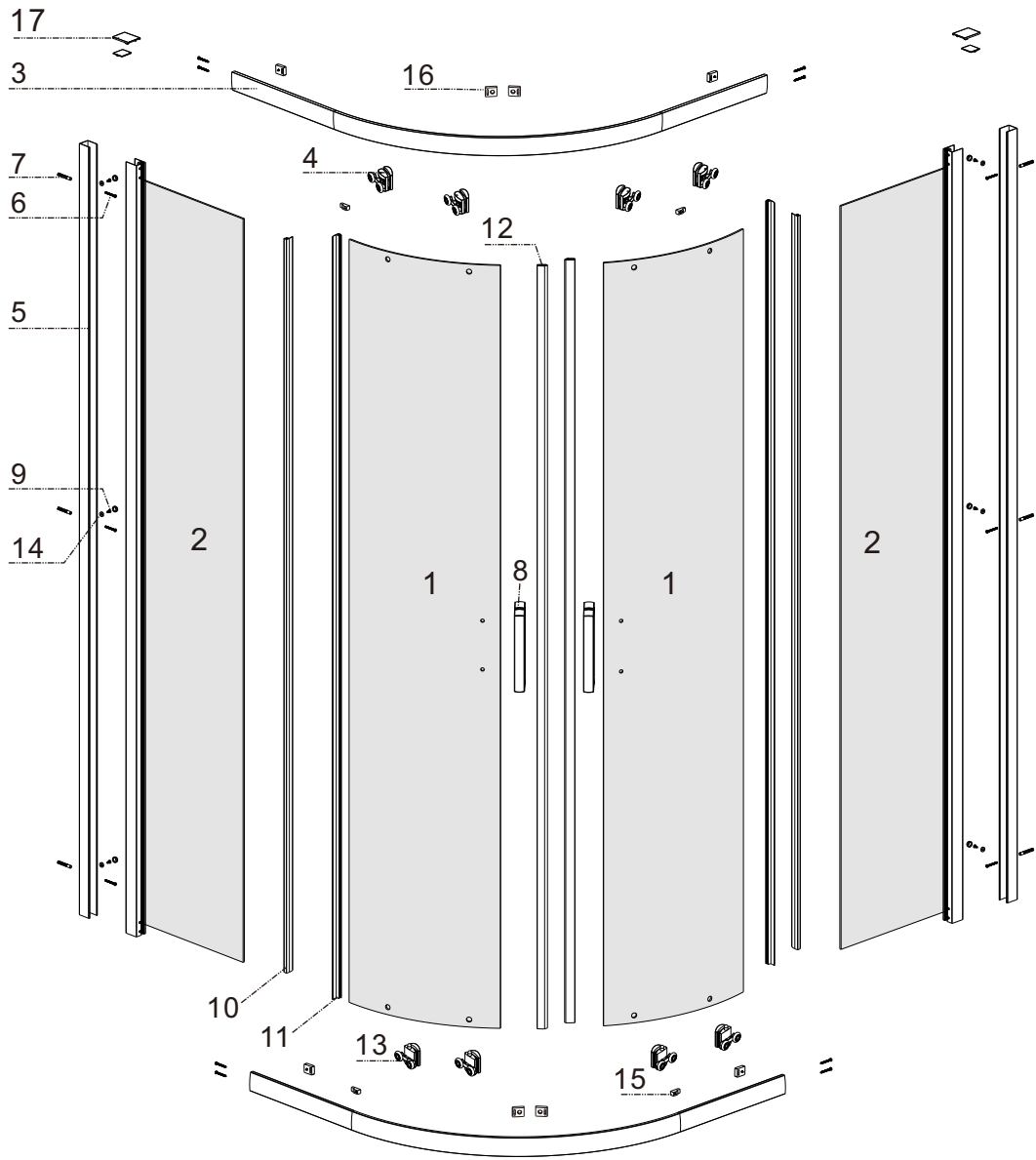

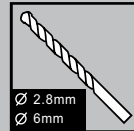
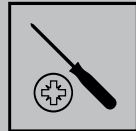
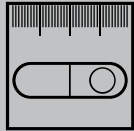

[1]



X2

[2]

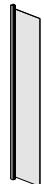

X2

[3]

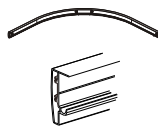

X2

[4]

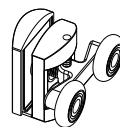

X4

[5]

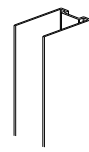

X2

[6]



ST3.5X32

X14

[7]

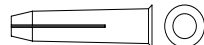

X6

[8]



X2

[9]



ST3.5X9.5

X18

[10]



X2

[11]

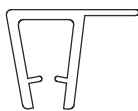

X2

[12]

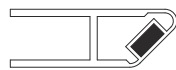

X2

[13]

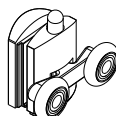

X4

[14]

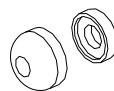

X6

[15]

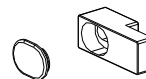

X4

[16]

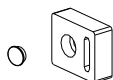

X8

[17]



X2



X2

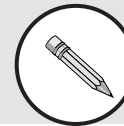
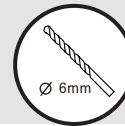
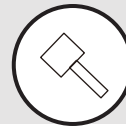
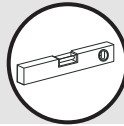
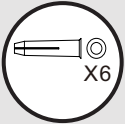

1

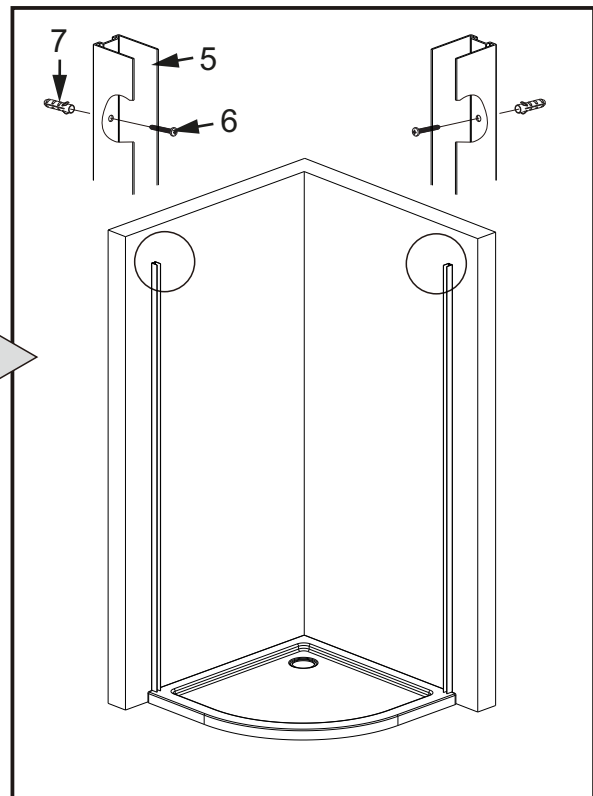
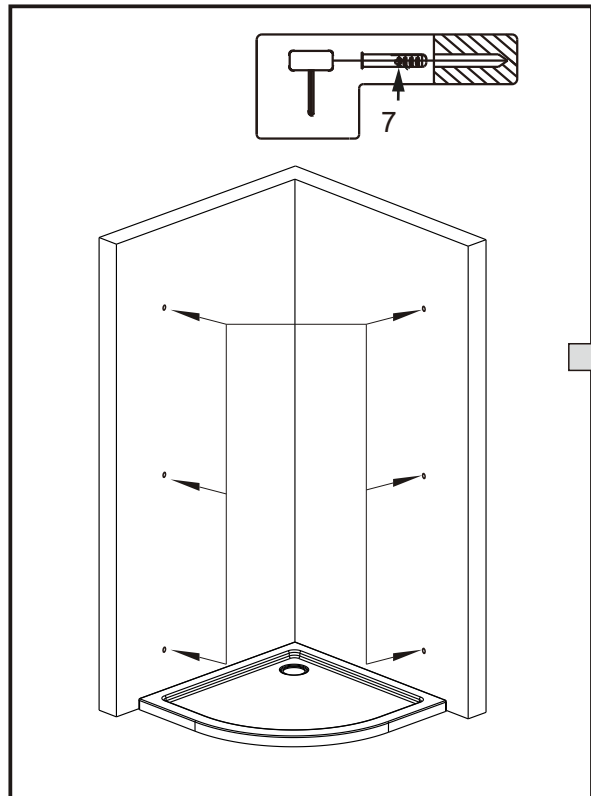
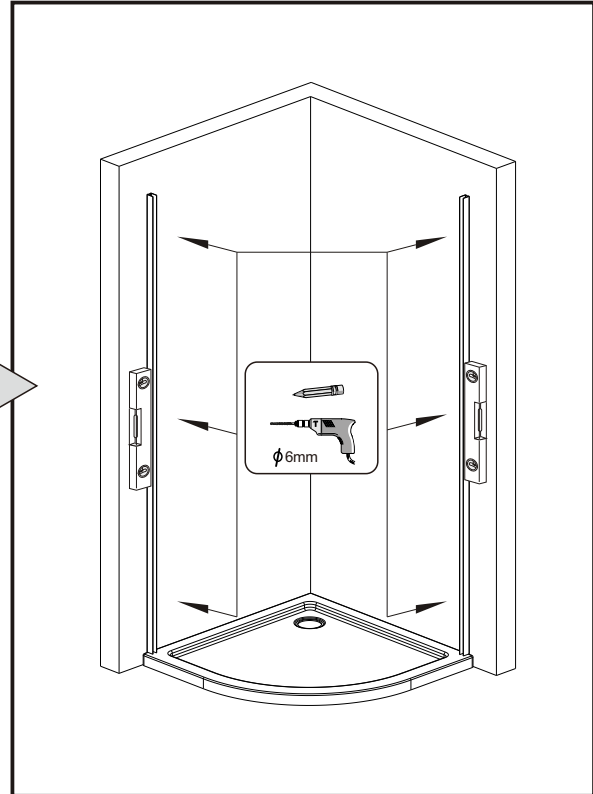
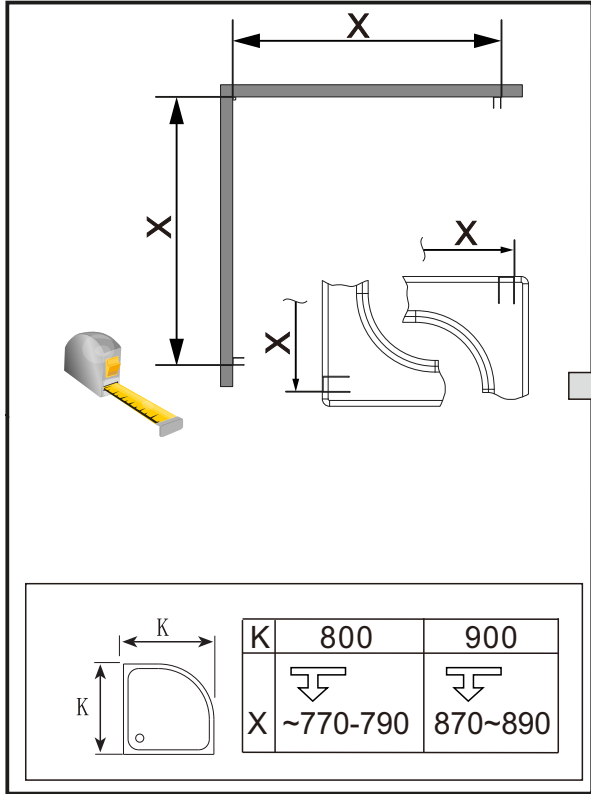

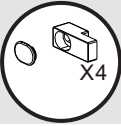
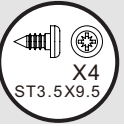
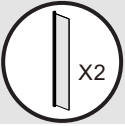
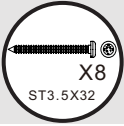

2

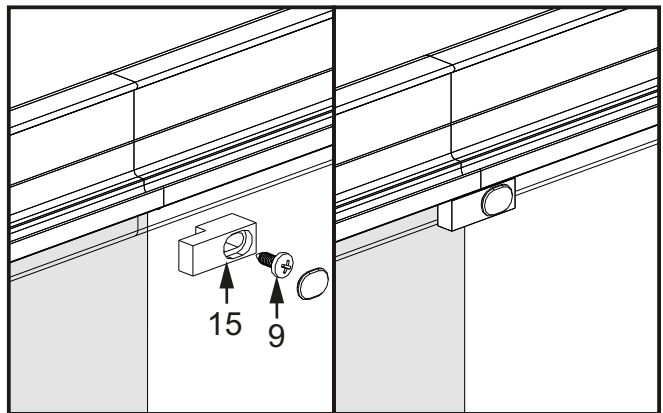
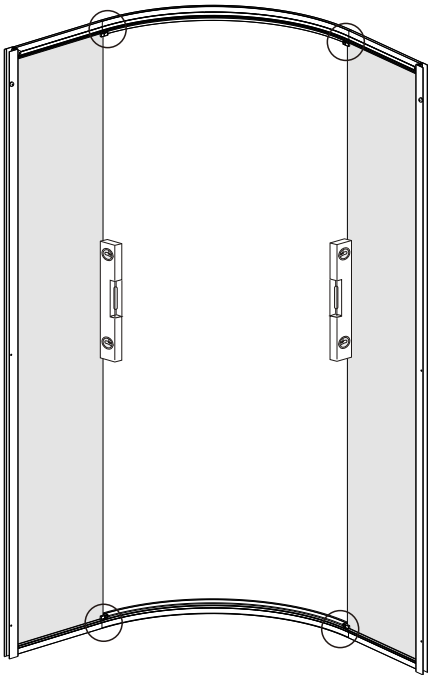
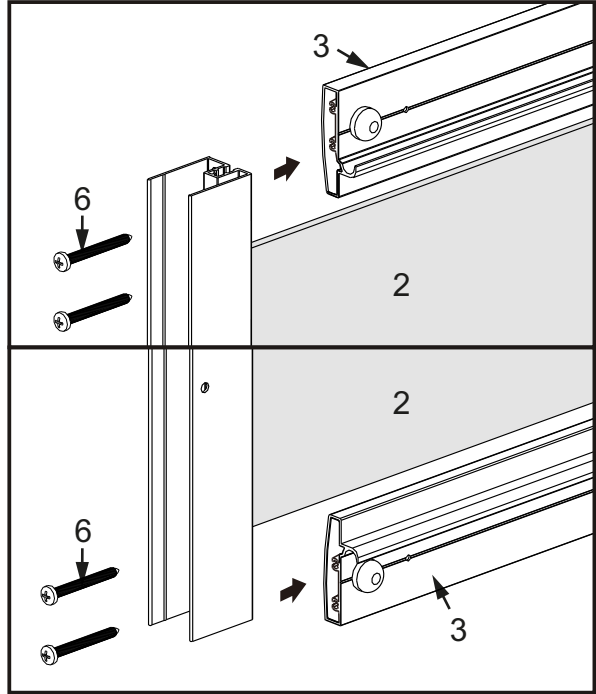
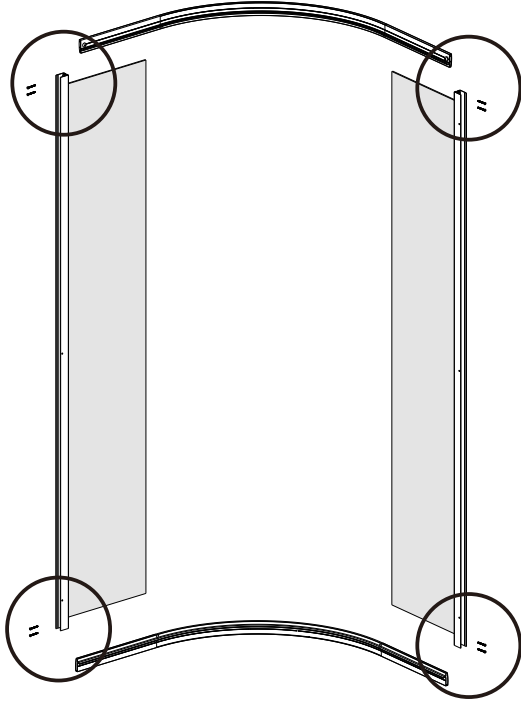



3

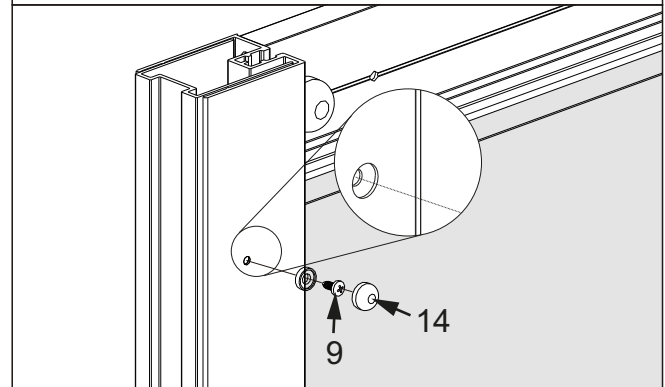
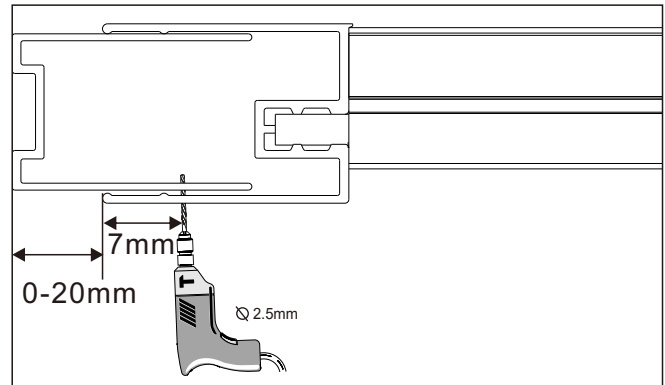
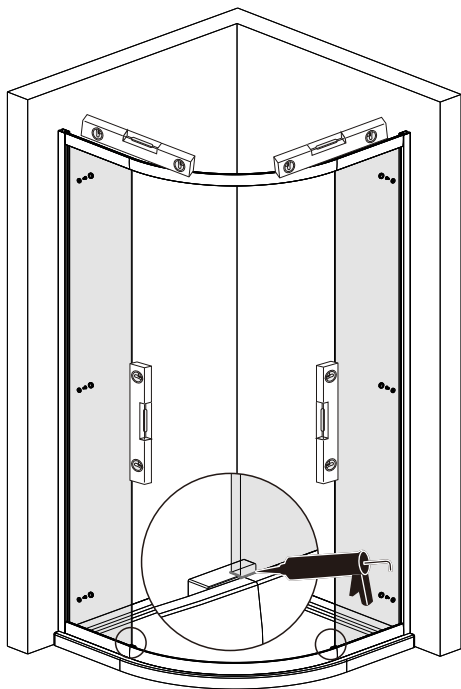
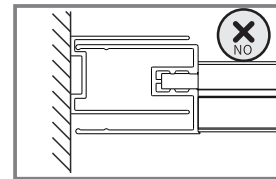
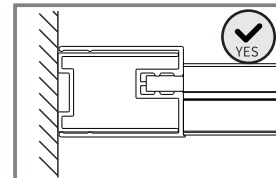
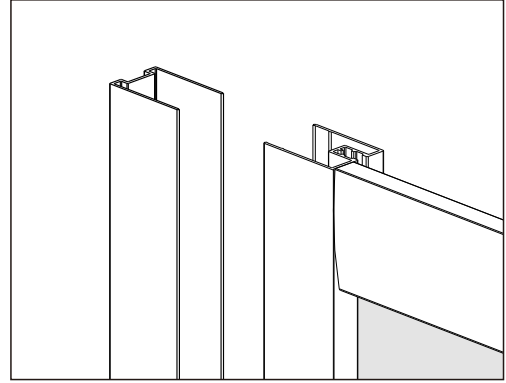
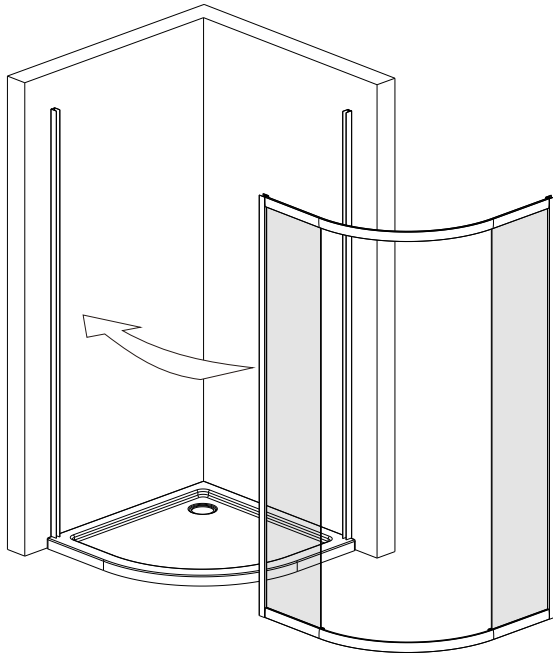

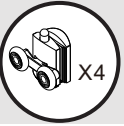
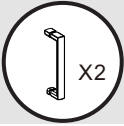

4

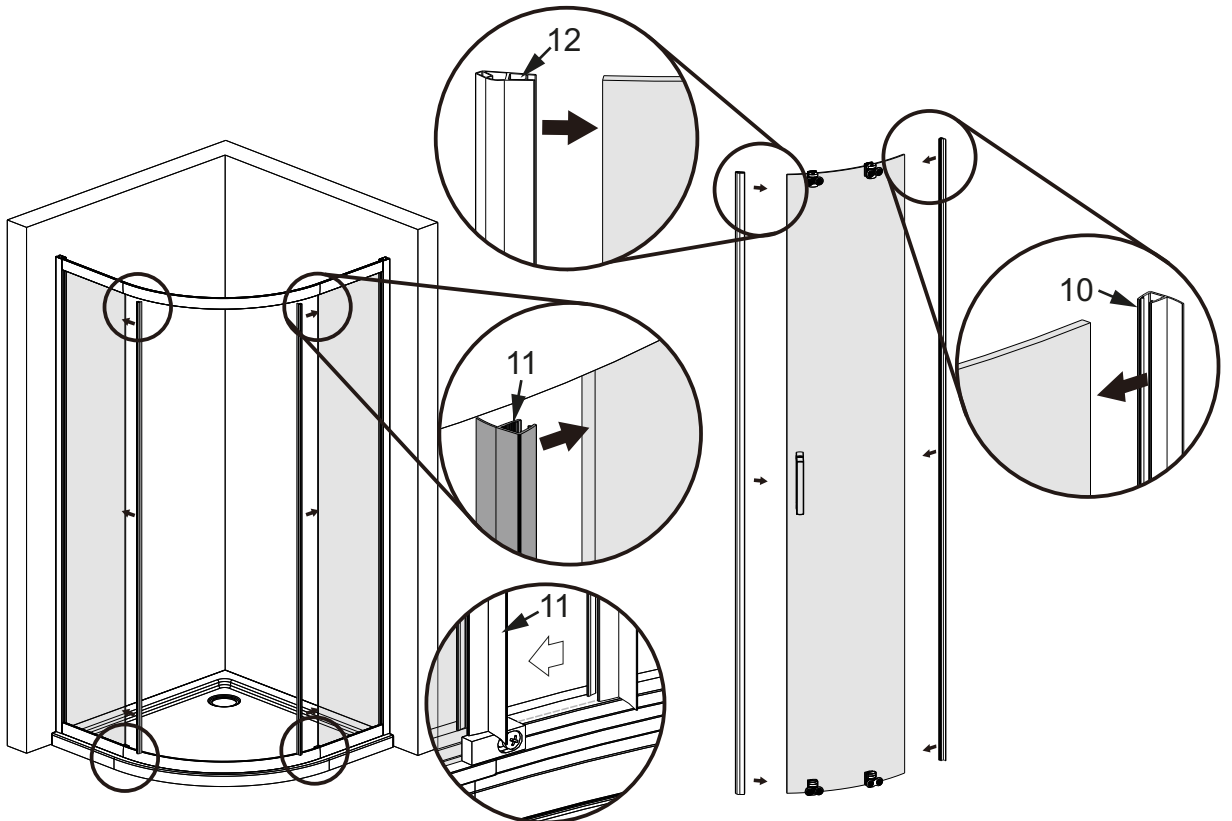
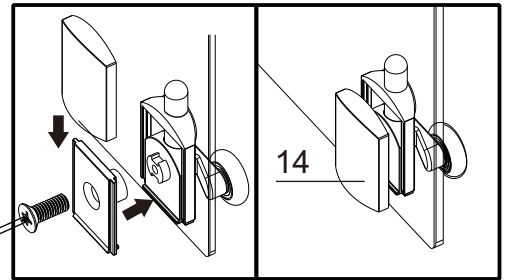
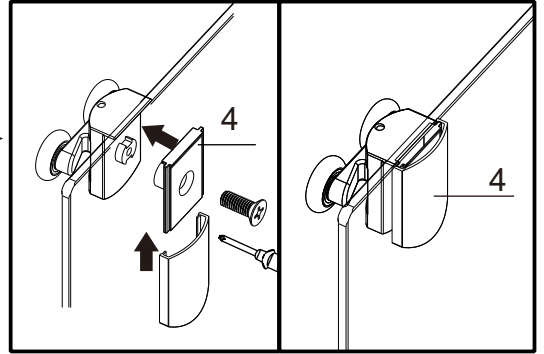
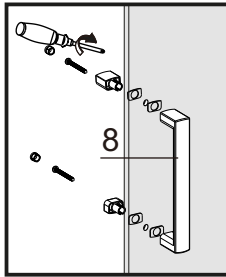
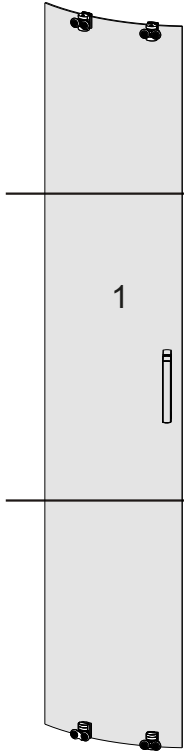

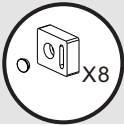

5

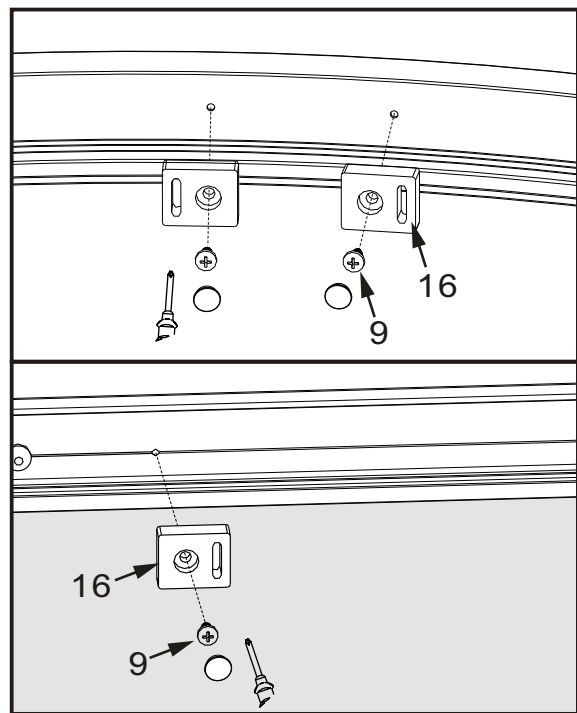
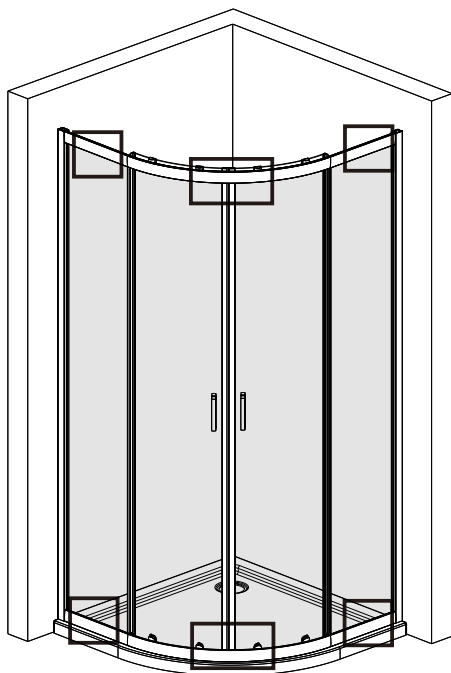
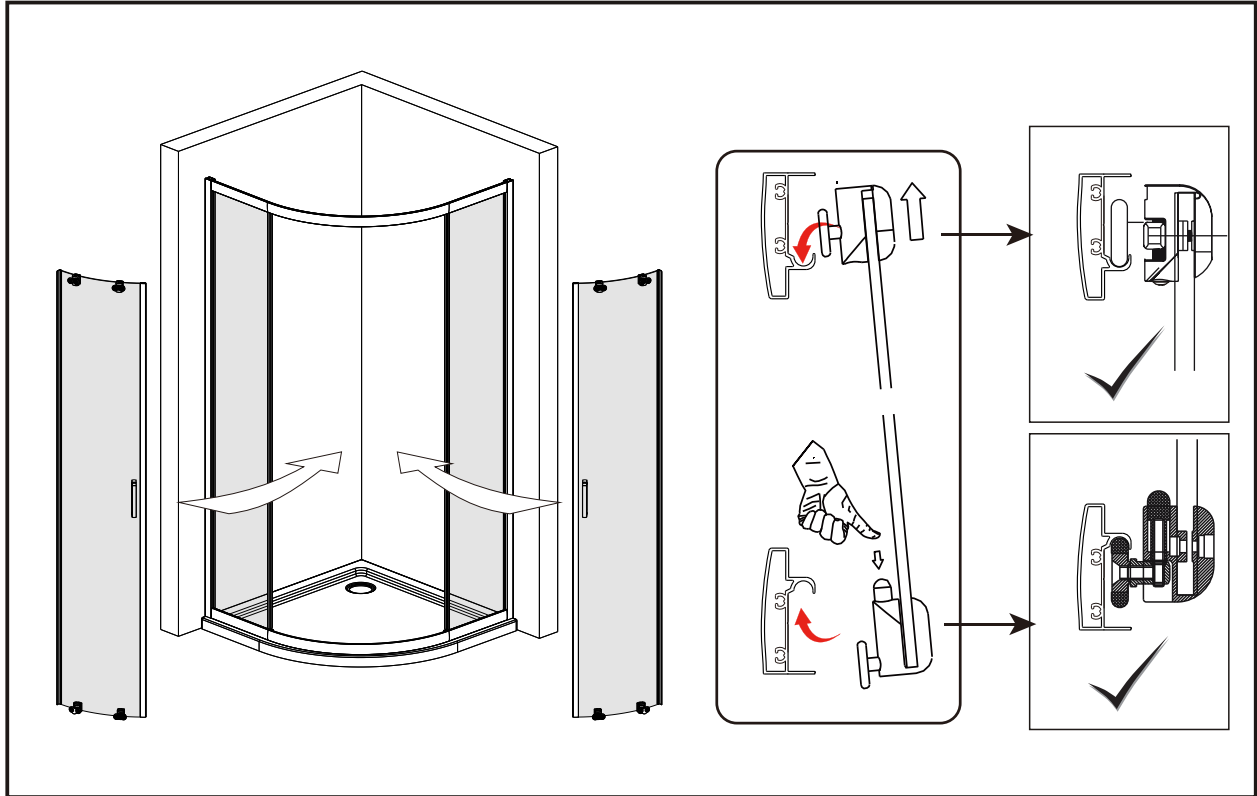

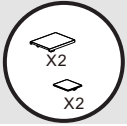

6

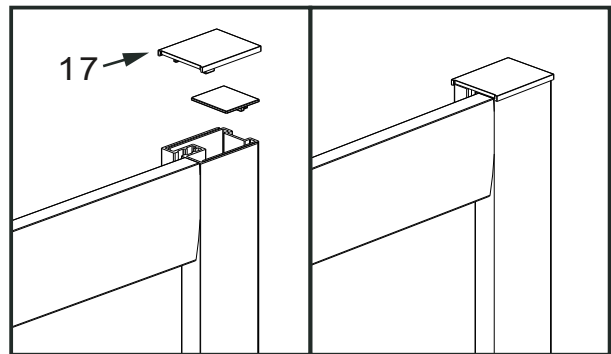
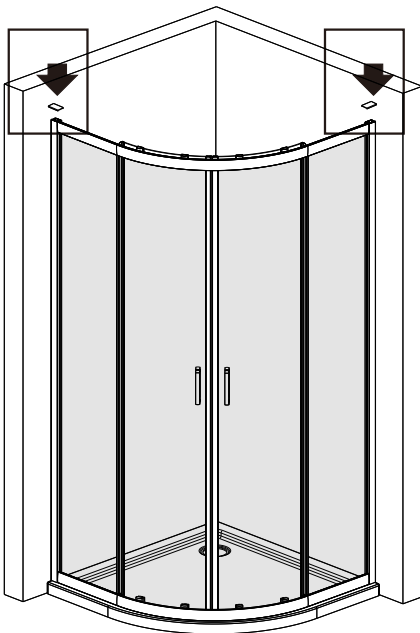
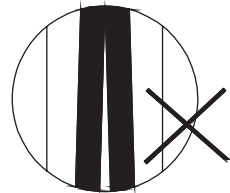
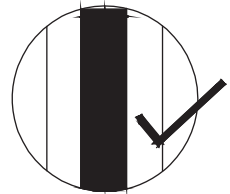
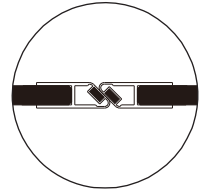
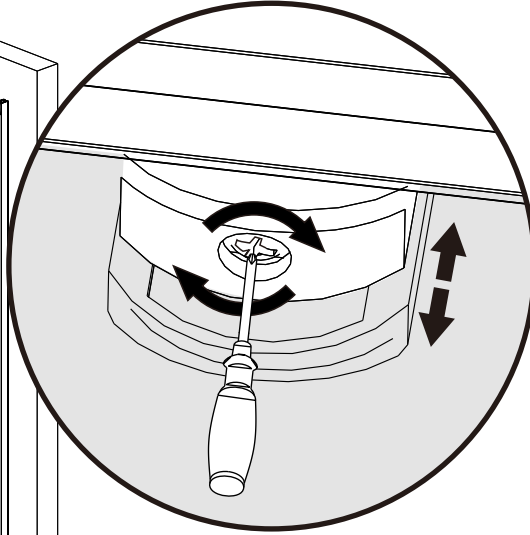
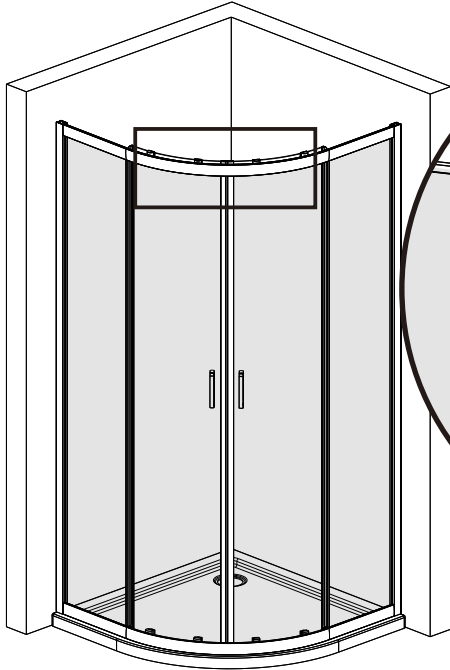



7

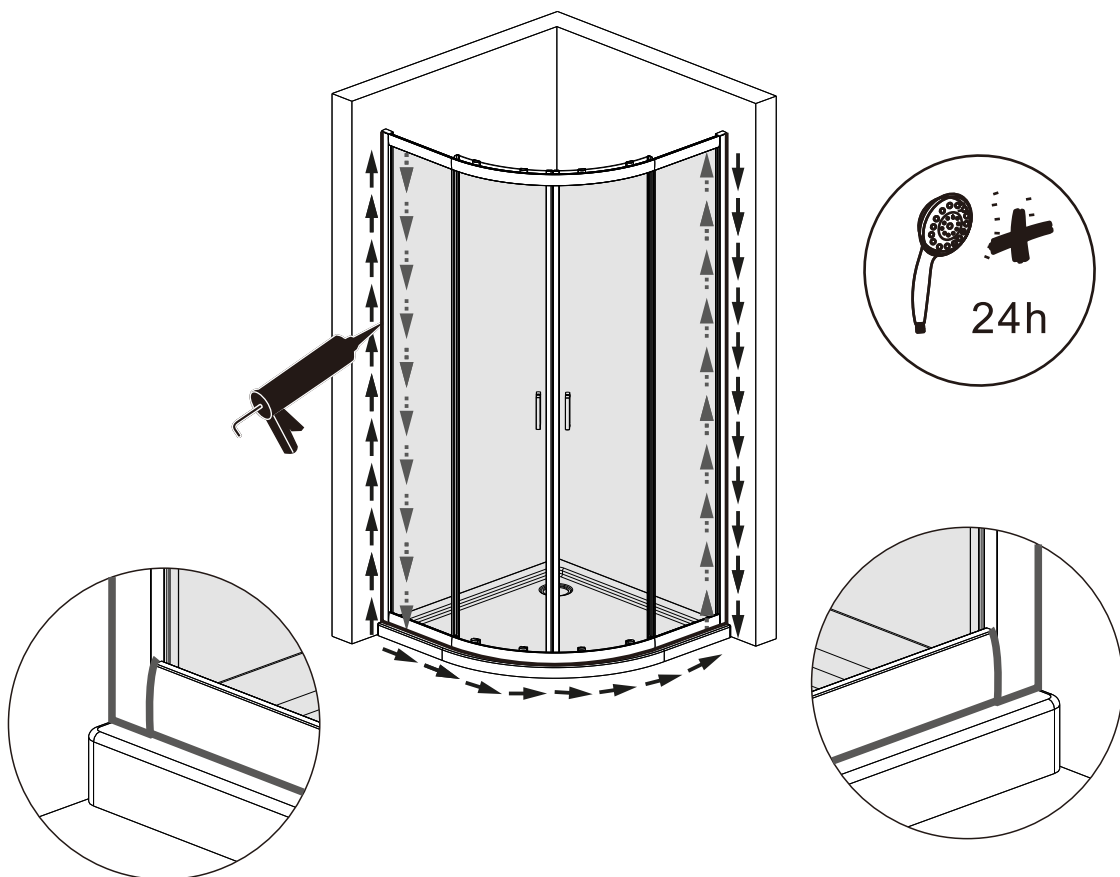

AVVERTENZE

Questo prodotto deve essere usato come **box doccia**. Operazioni per le quali lo strumento non è stato progettato possono creare un pericolo e/o causare danni al prodotto.

- Non appendere oggetti o complementi pesanti sulla struttura del box doccia.
- Non arrampicarsi sul box doccia.
- Maneggiare il vetro con estrema cautela e fare attenzione a non fargli prendere colpi / urti.

PULIZIA E MANUTENZIONE

Utilizzare acqua saponata calda e un panno soffice leggermente inumidito per pulire il vetro. Asciugare accuratamente con un panno morbido e asciutto. Non usare alcun detergente chimico aggressivo o abrasivo né spugnette abrasive per la pulizia dei vetri e dei profili al fine di non rovinare la superficie del prodotto. E' possibile utilizzare un detergente apposito per i vetri, se necessario.

Pulire il profilo di scorrimento regolarmente.

Se l'acqua è molto calcarea e si lascia che i residui si depositino sui vetri, sarà molto difficile rimuoverli. Si consiglia quindi di pulire regolarmente i pannelli di vetro e i profili per minimizzare questo effetto.